

**TOTAL EXTENT (AS PER SUB-DIVISION PLAN) : 13233 SQ.M ✓**  
**ROAD AREA : 1449 SQ.M ✓**  
**PARK AREA : 1184 SQ.M ✓**  
**TOTAL NO. OF PLOTS : 2 Nos. ✓**

**NOTE:**  
 ROAD AREA ] WERE HANDED OVER TO THE LOCAL BODY VIDE GIFT DEED  
 PARK AREA ] DOC.NO: 15465 / 2018, DATED: 13-11-2018 @ SRO, AMBATTUR

**CONDITIONS :**  
 DR RULE NO: 29 (11)  
 THE COST OF LAYING IMPROVEMENTS TO THE SYSTEMS INRESPECT OF ROAD, WATER SUPPLY, SEWERAGE, DRAINAGE OR ELECTRIC POWER SUPPLY THAT MAY BE REQUIRED AS ASSESSED BY THE COMPETENT AUTHORITY, SHALL BE BORNE BY THE APPLICANT.

**LEGEND:**  
 [ ] SITE BOUNDARY ✓  
 [ ] ROADS GIFTED TO THE LOCAL BODY ✓  
 [ ] EXISTING ROAD ✓  
 [ ] PARK GIFTED TO THE LOCAL BODY ✓

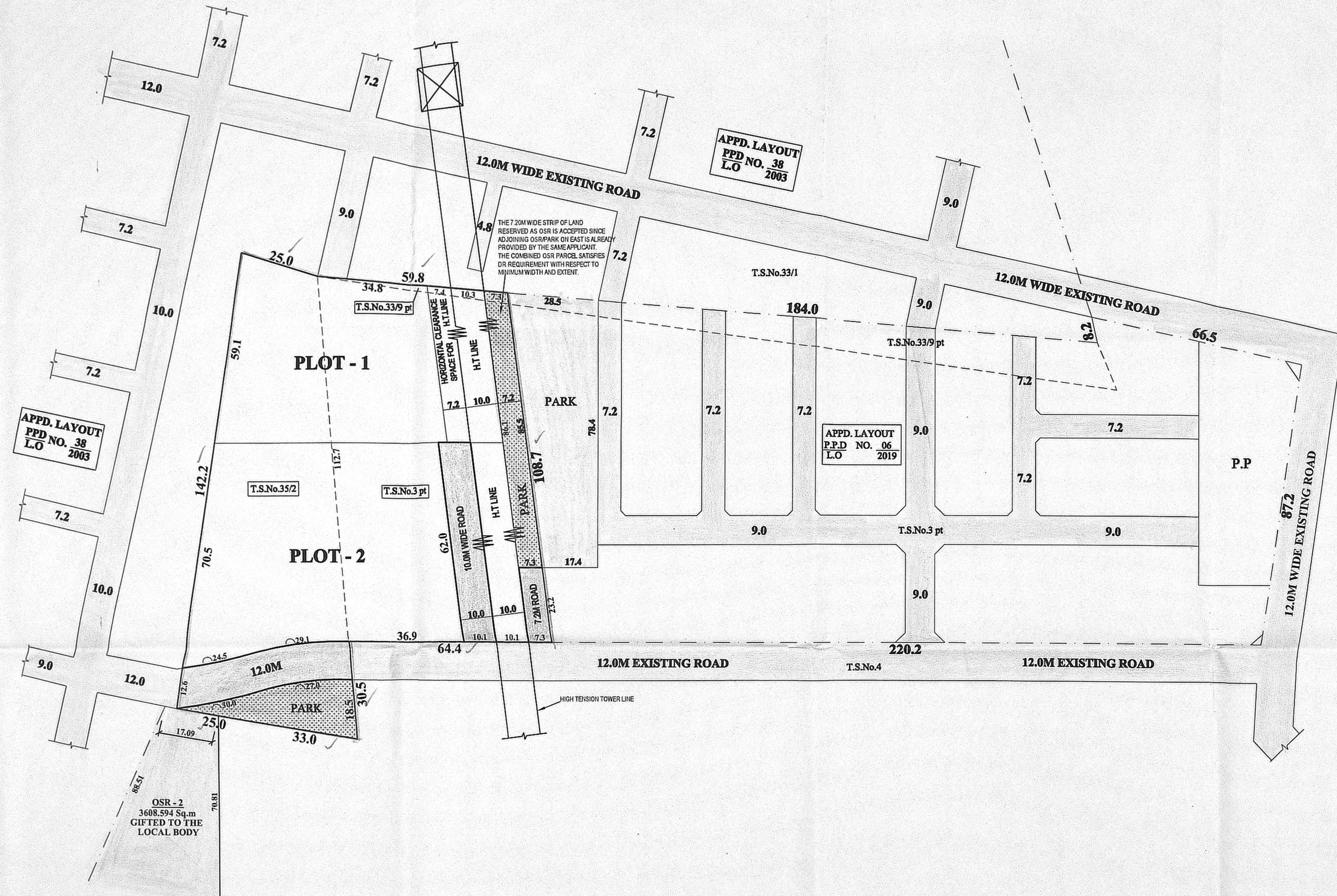

**CONDITIONS:**  
 THE LAYOUT APPROVED IS VALID SUBJECT TO OBTAINING SANCTION FROM THE LOCAL BODY CONCERNED.

P.P.D NO : 16  
 L.O 2019

**APPROVED**

VIDE LETTER NO : L1 / 13766 / 2018  
 DATE : / 02 / 2019

FOR MEMBER SECRETARY  
 CHENNAI METROPOLITAN  
 DEVELOPMENT AUTHORITY

PREPARED BY P.A-IV (S.M)  
 CHECKED BY P.A.II (N.B.V)  
 A.P.V.S.A 04/02/2019

**AVADI GREATER MUNICIPALITY**  
 SUB-DIVISION OF HOUSE SITES IN T.S.No.3 pt (OLD S.No: 209/2pt) IN BLOCK No:46 & T.S.No.33/9 pt (OLD S.No. 696/1pt, 2pt), T.S.No.35/2 (OLD S.No. 692/2, 693)  
 IN BLOCK No:42, WARD-D OF THIRUMULAIVOYAL VILLAGE.

SCALE : 1:800 (ALL MEASUREMENTS ARE IN METRE.)

